

# Assembly Instruction

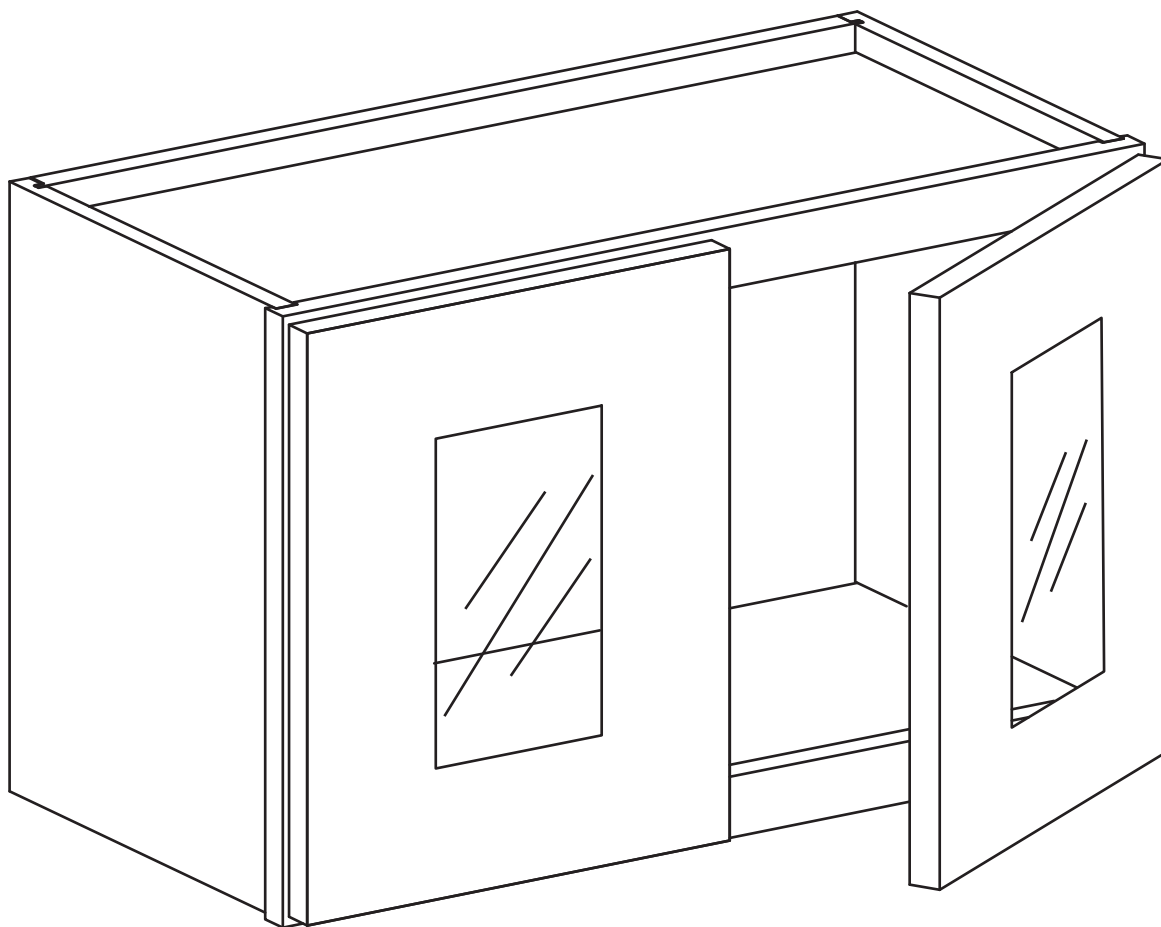

## Wall Cabinet Glass Insert Door

Item Code:

WM2412H, WM2712H, WM3012H, WM3312H, WM3612H, WM3018H

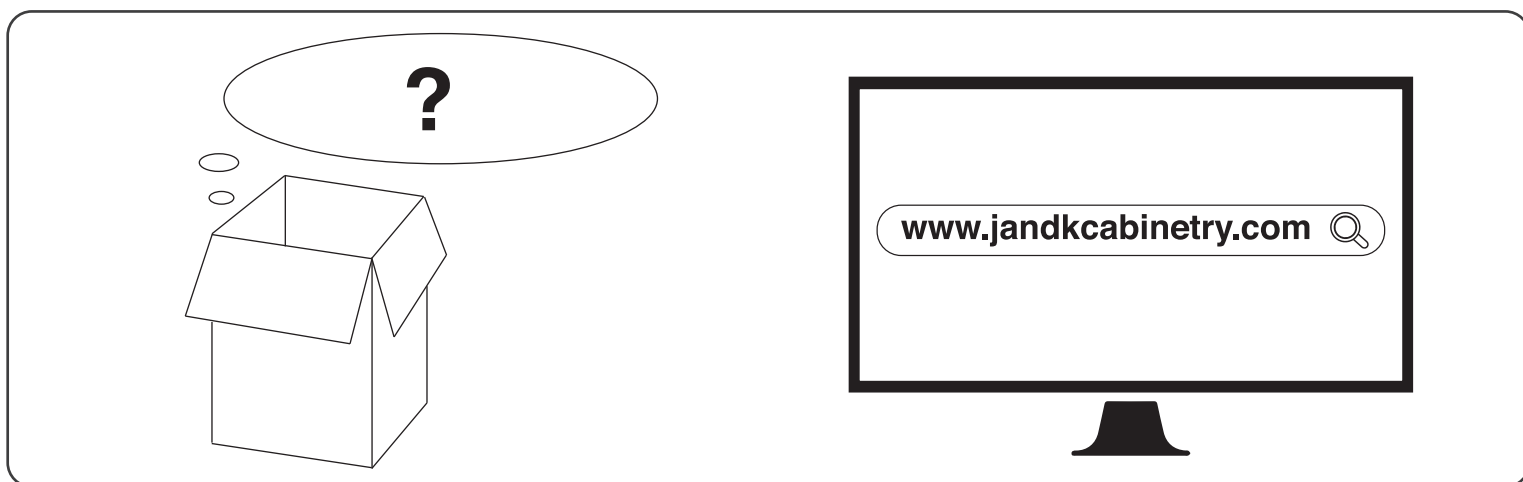
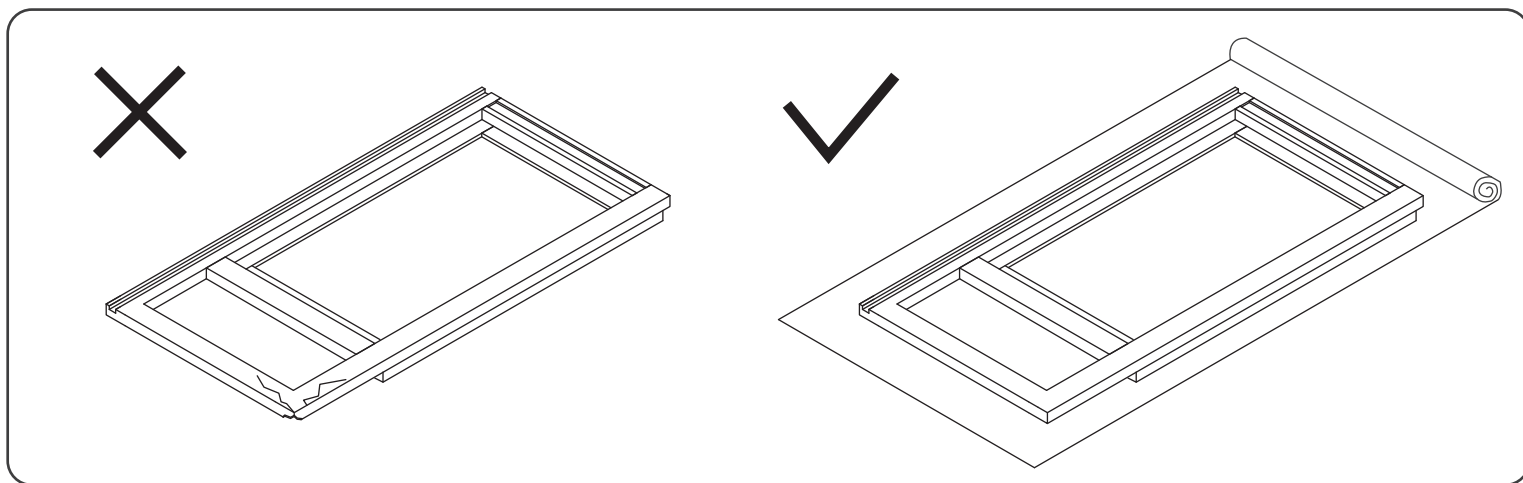

## **WARNING:**

1. Please be careful when opening the box with boxcutter and/or blade.
2. J&K Cabinetry is not responsible for any injuries and/or damages incurred during cabinet assembly.





## **SERVICE:**

During the installation process, if you encounter any problems, please go to our official website: [www.jandkcabinetry.com](http://www.jandkcabinetry.com), check the full version assembly instruction or watch the assembly video online.

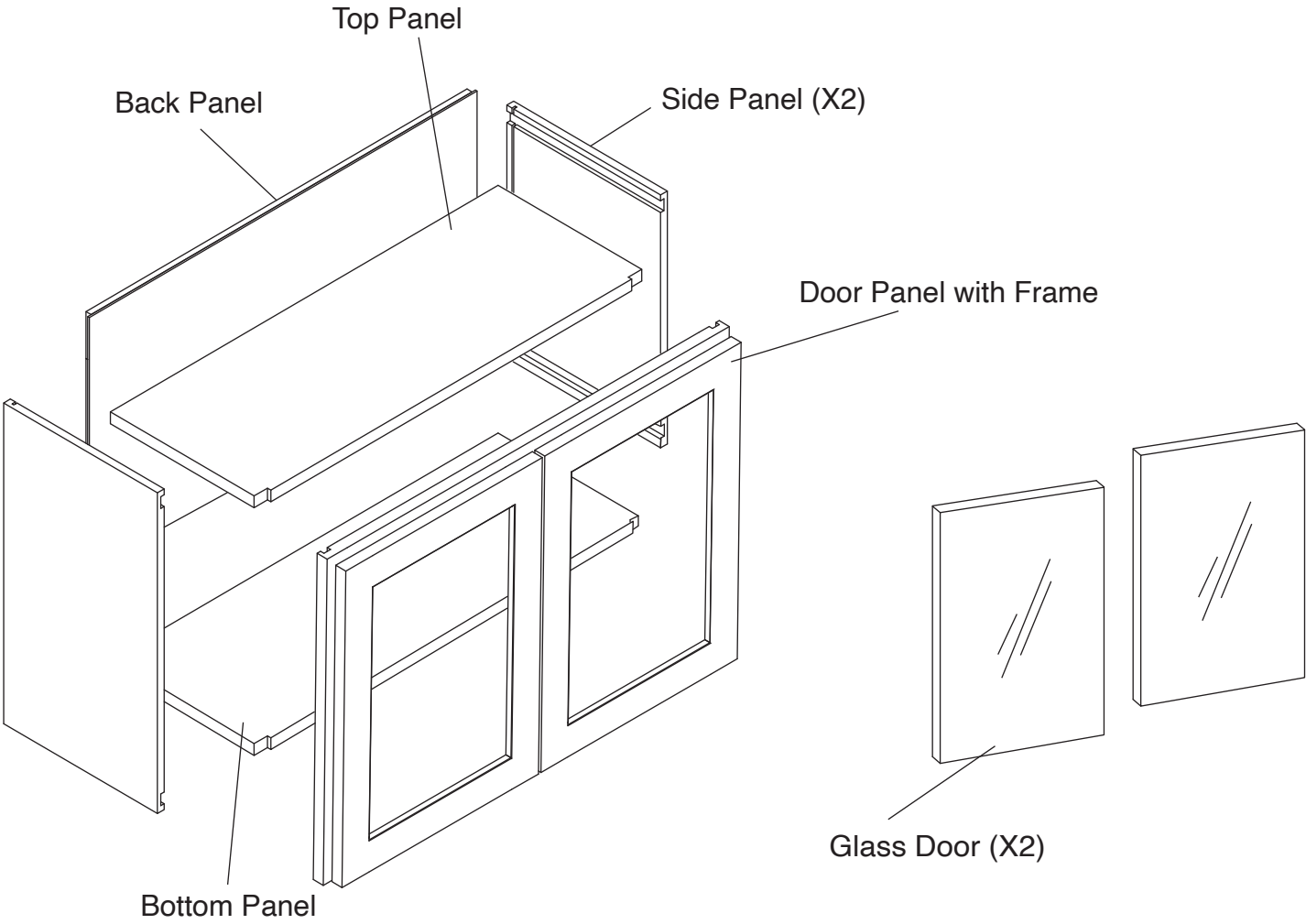
Included Items:



*Notes: Glass Doors NOT Included*

1-3/16"		
Screws X 8	Door Bumpers X 4	

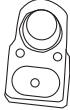
3/5"		
Screws X 8	Glass Door Retainer Clips X 8	

Recommended Tools:



Safety Tools:



### Step 1:

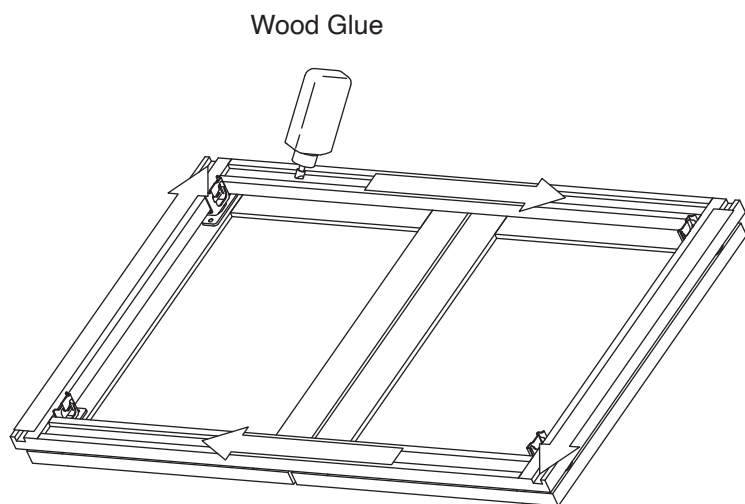

### Step 2:

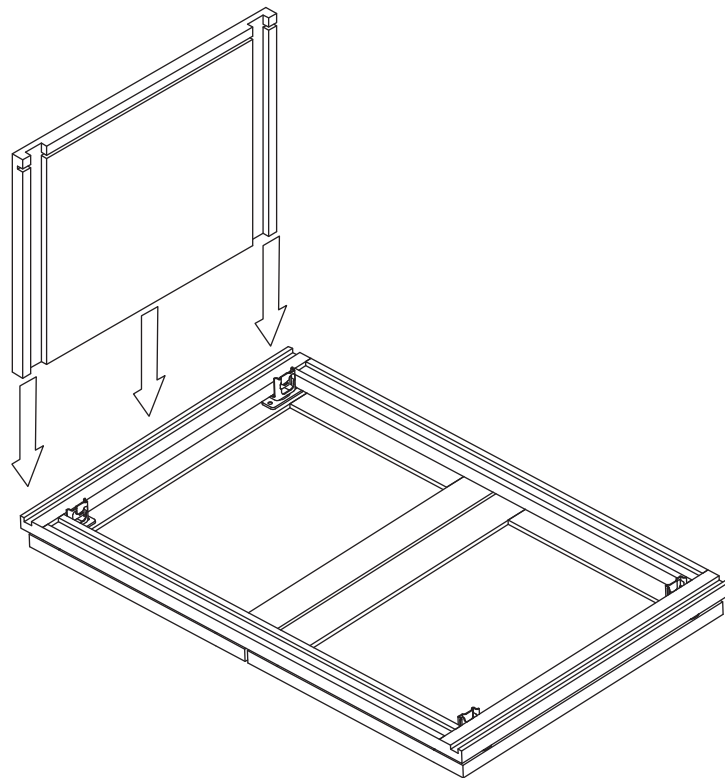

### Step 3:

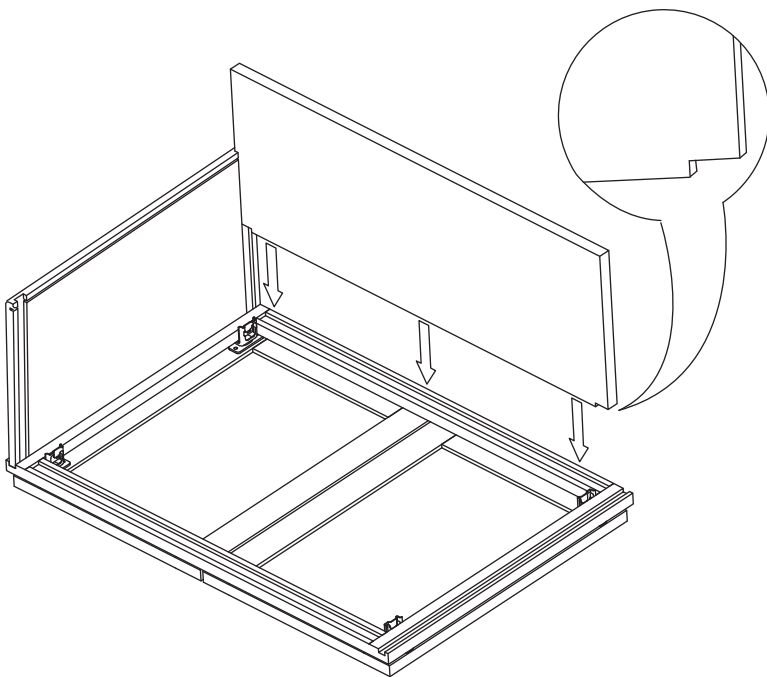

### Step 4:

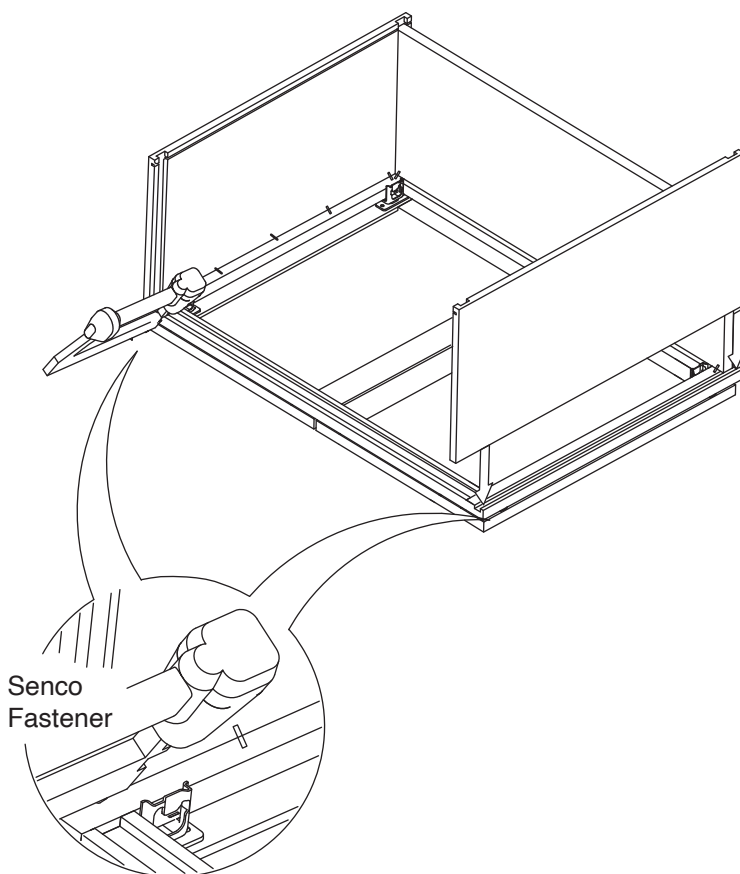



### Step 5:

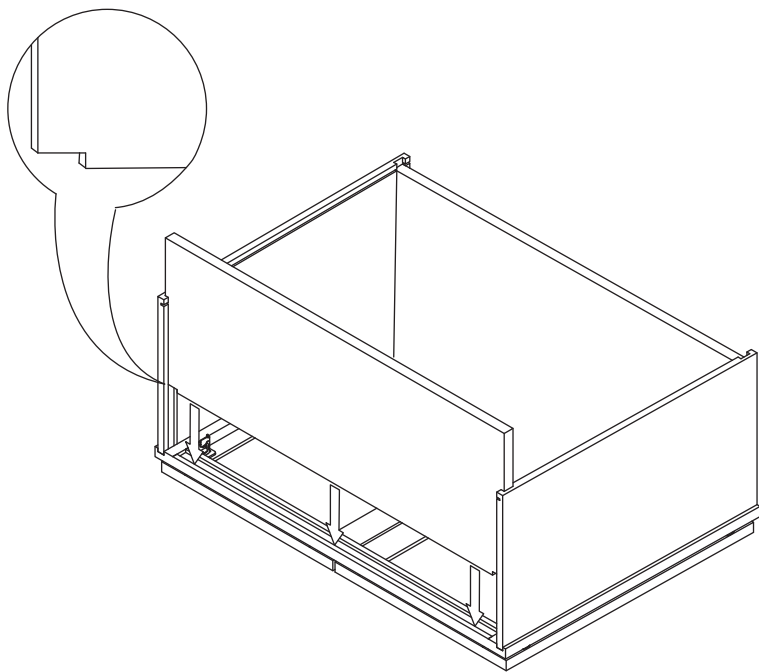

### Step 6:

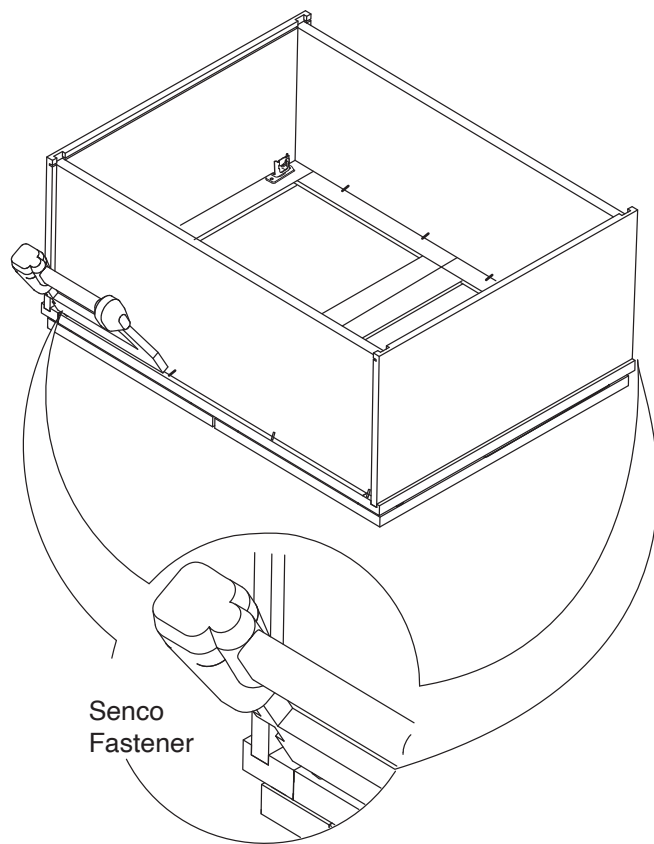

### Step 7:

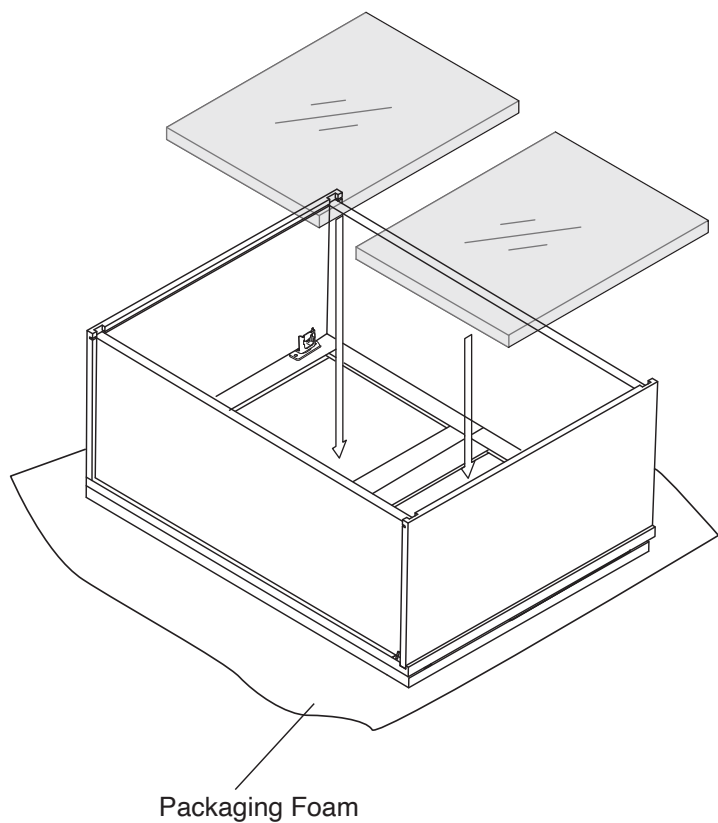

### Step 8:

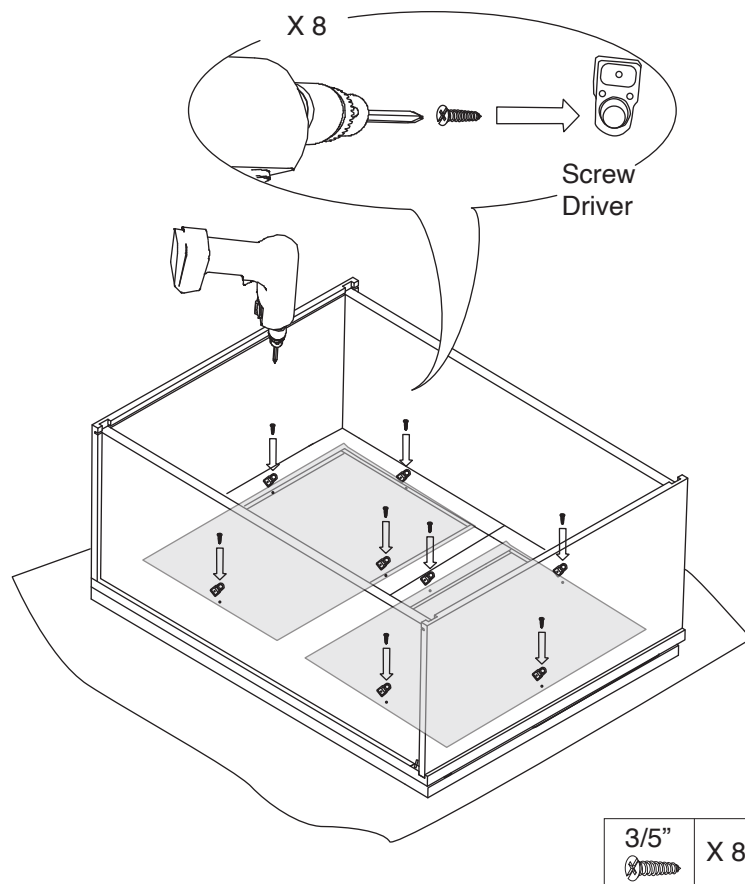

Step 9:

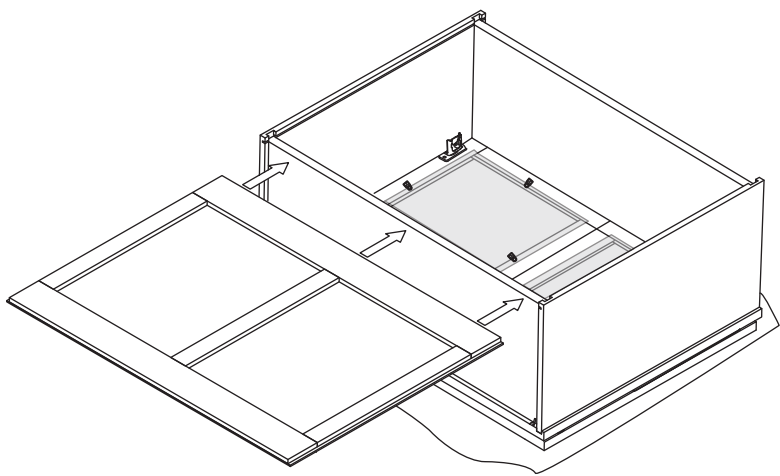

Step 10:

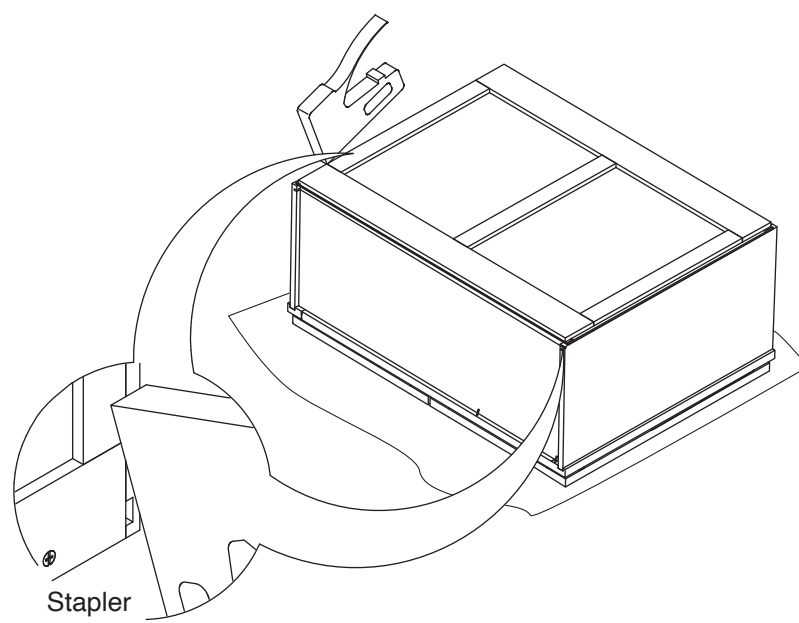

Step 11:

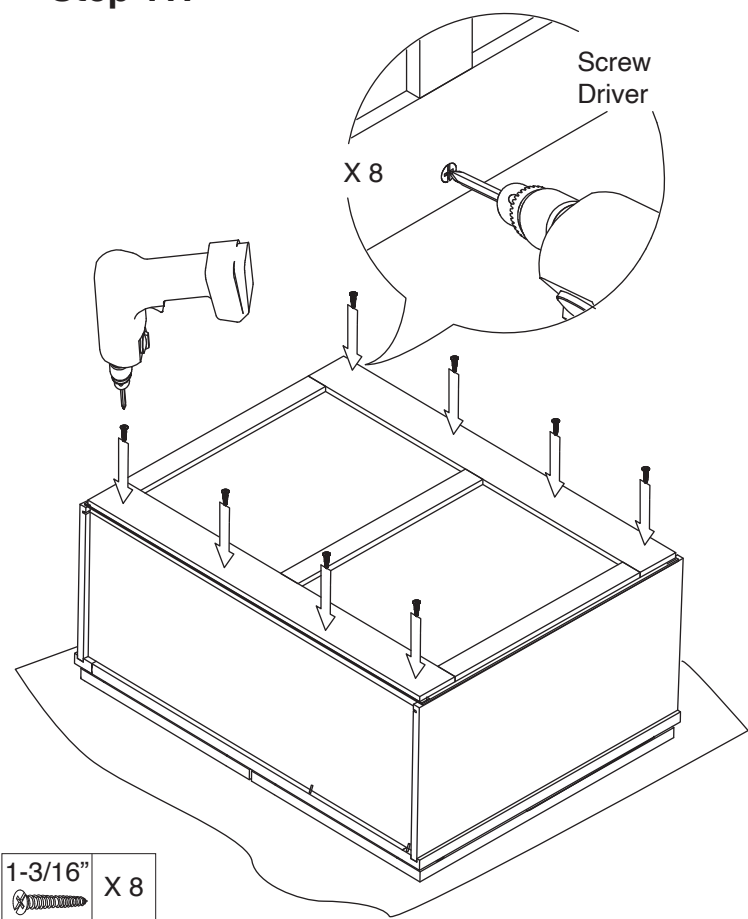

Step 12:

