

# Assembly Instruction

2020 Edition

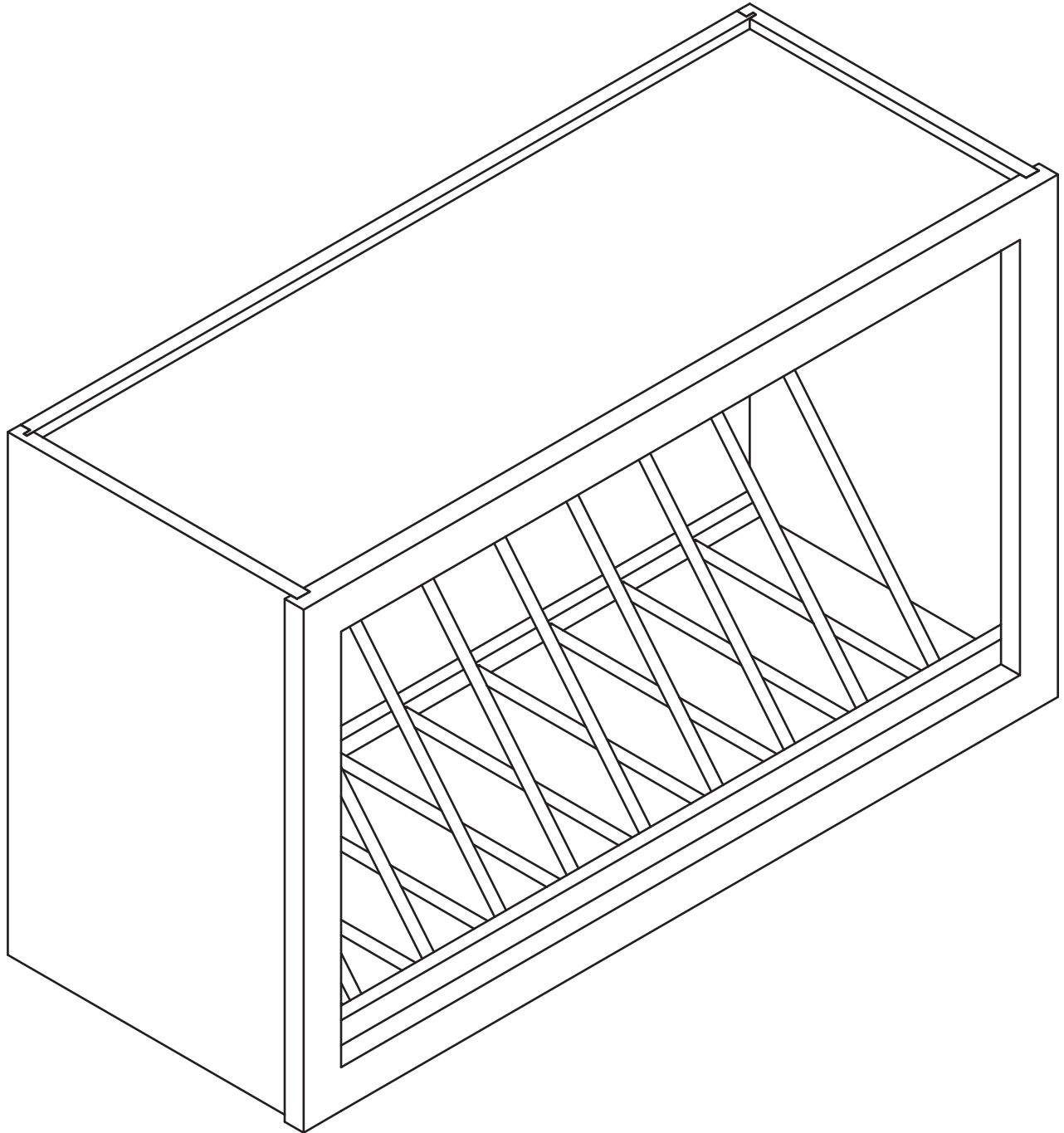

## Plate Rack

Item Code:

WCD3015, WCD3615

WCD3018, WCD3618

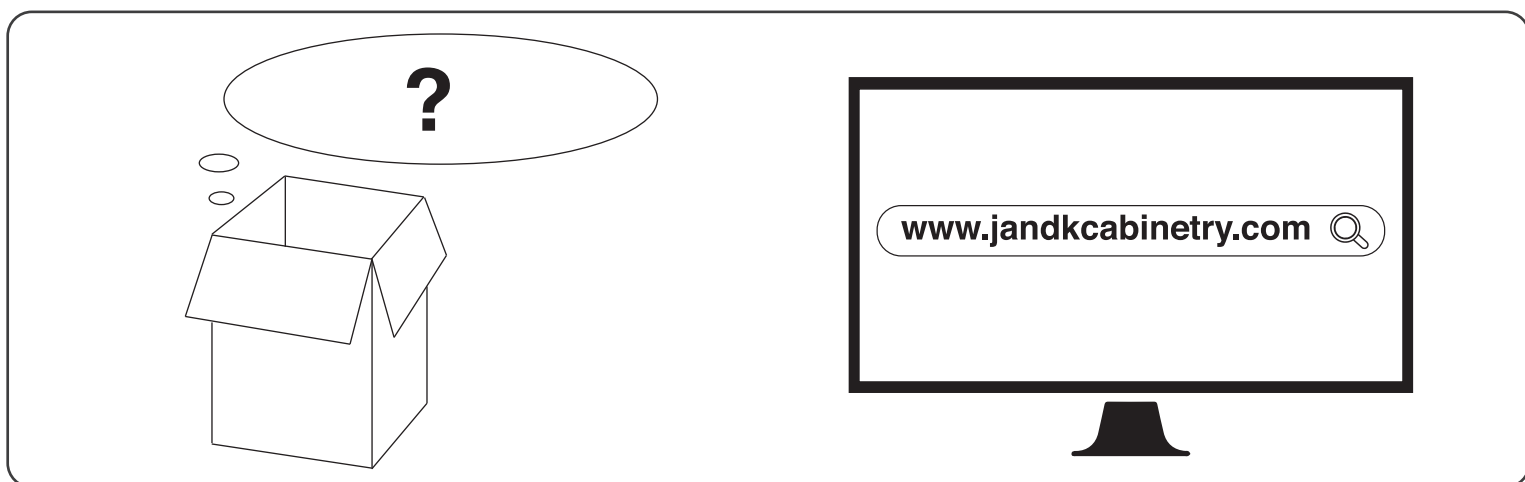
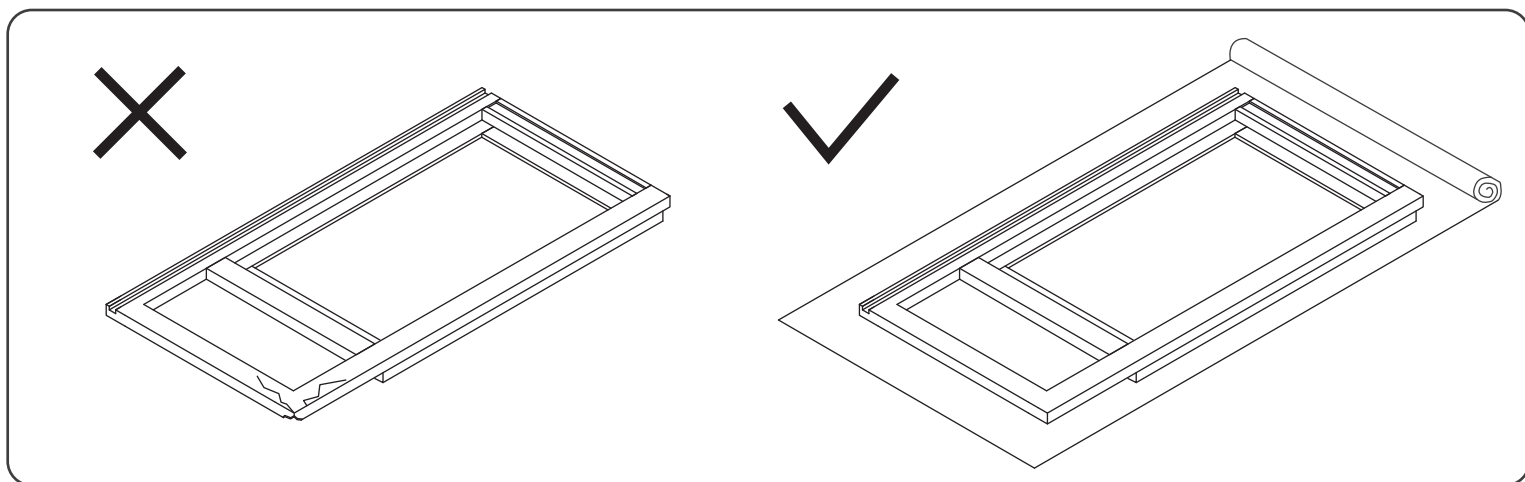

## **WARNING:**

1. Please be careful when opening the box with boxcutter and/or blade.
2. J&K Cabinetry is not responsible for any injuries and/or damages incurred during cabinet assembly.

## **SERVICE:**

During the installation process, if you encounter any problems, please go to our official website: [www.jandkcabinetry.com](http://www.jandkcabinetry.com), check the full version assembly instruction or watch the assembly video online.

## Included Items:

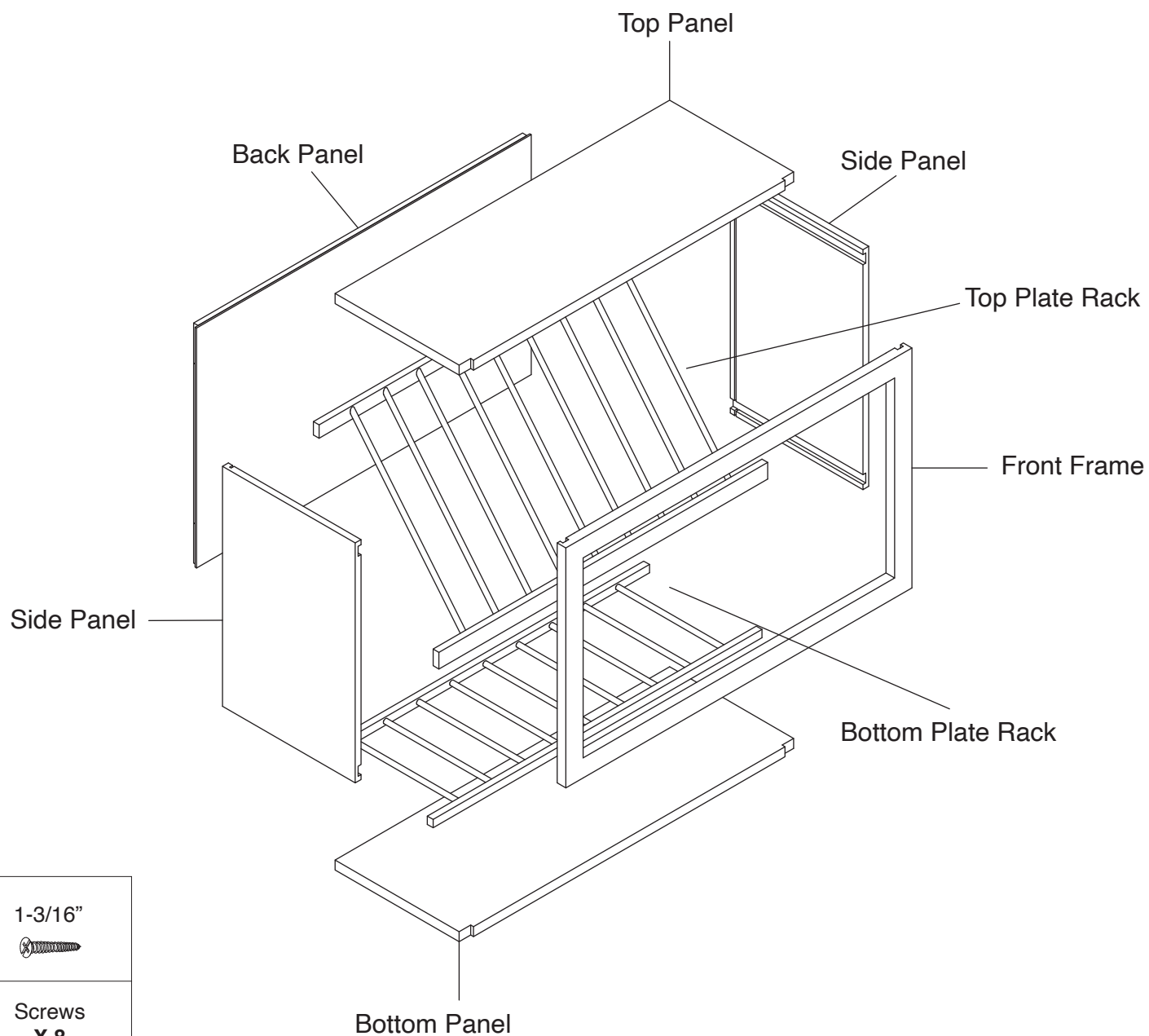

## Recommended Tools:



Wood Glue



Screw Driver



Rubber Mallet



Compressor



Nail Gun



Stapler



Senco Fastener

## Safety Tools:



Eye Wear



Gloves

### Step 1:

Wood Glue

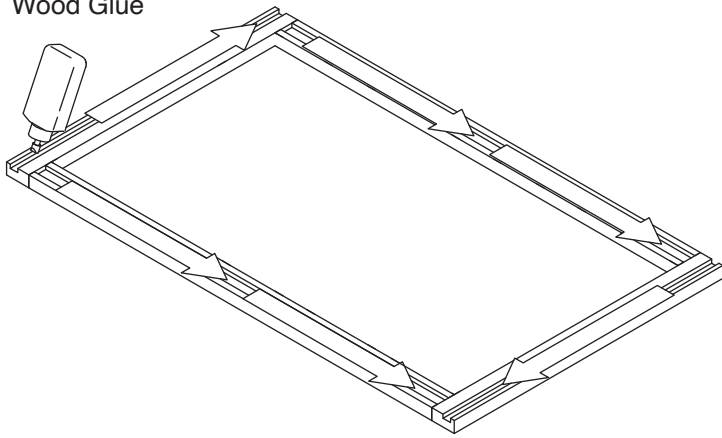

### Step 2:

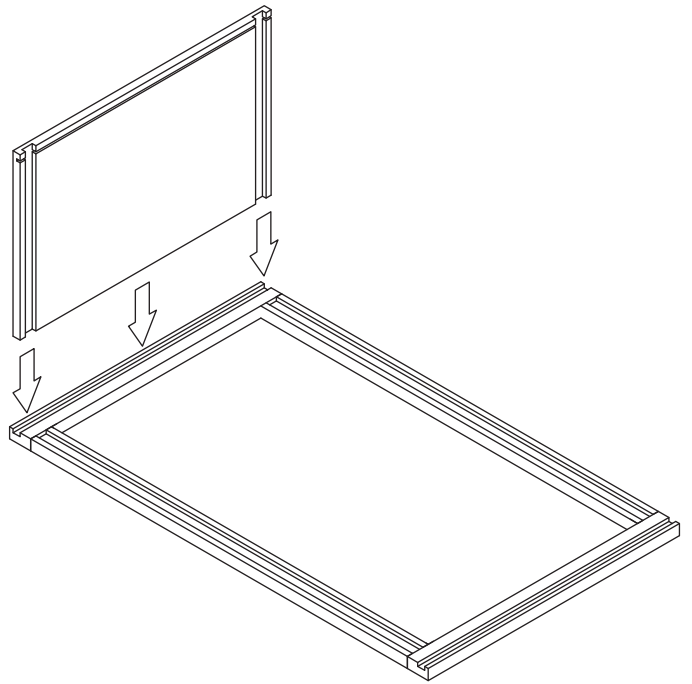

### Step 3:

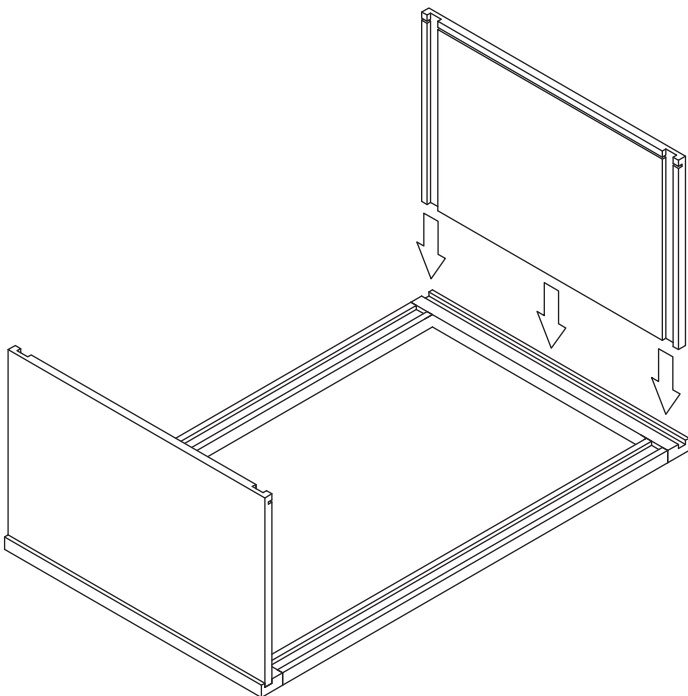

### Step 4:

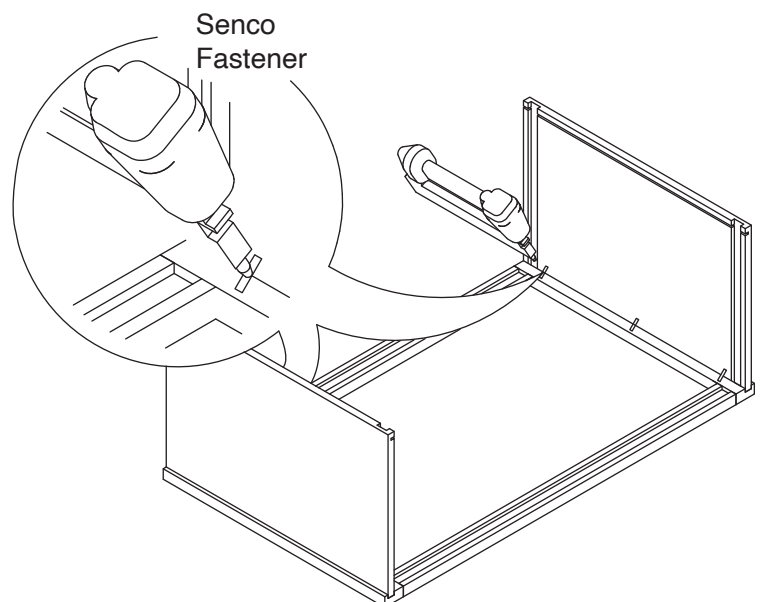



### Step 5:

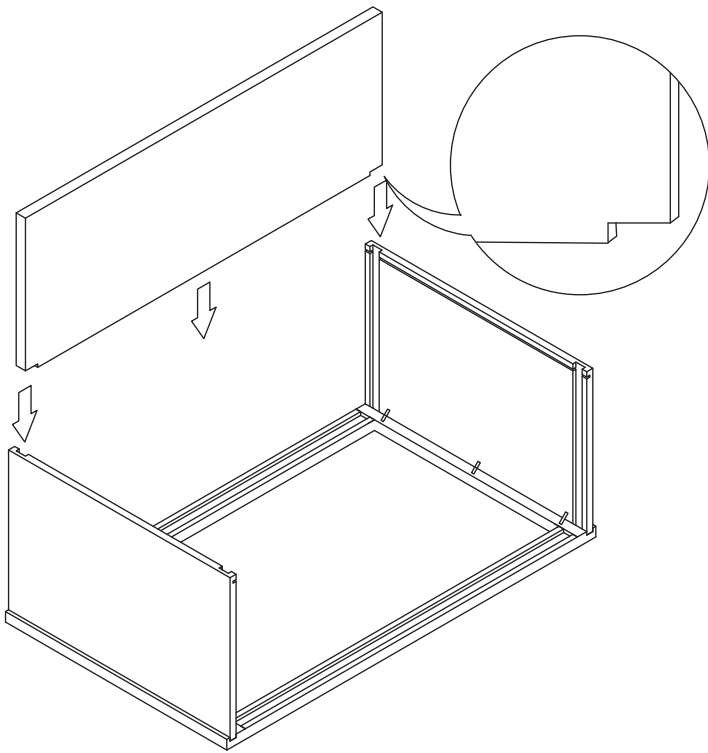

### Step 6:

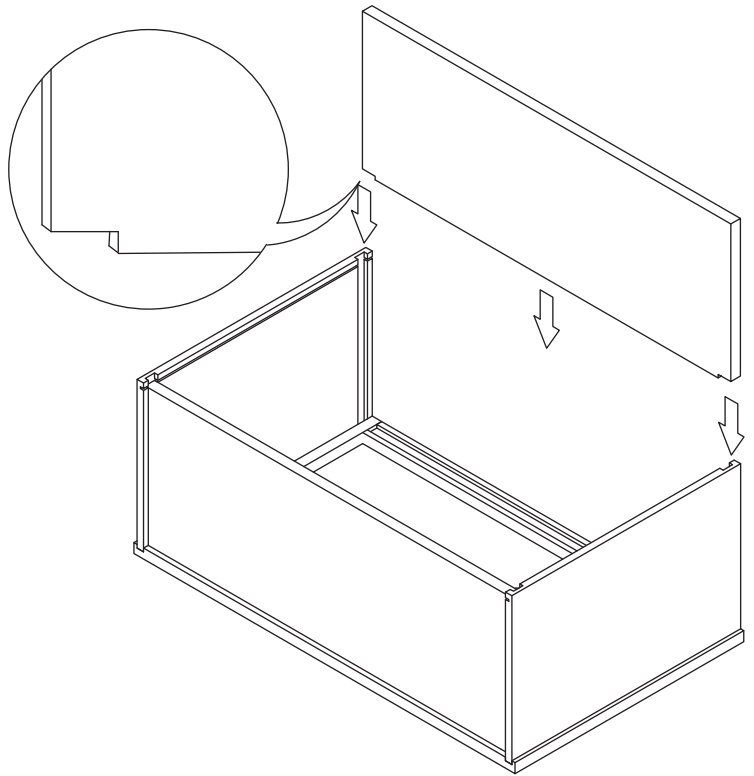

### Step 7:

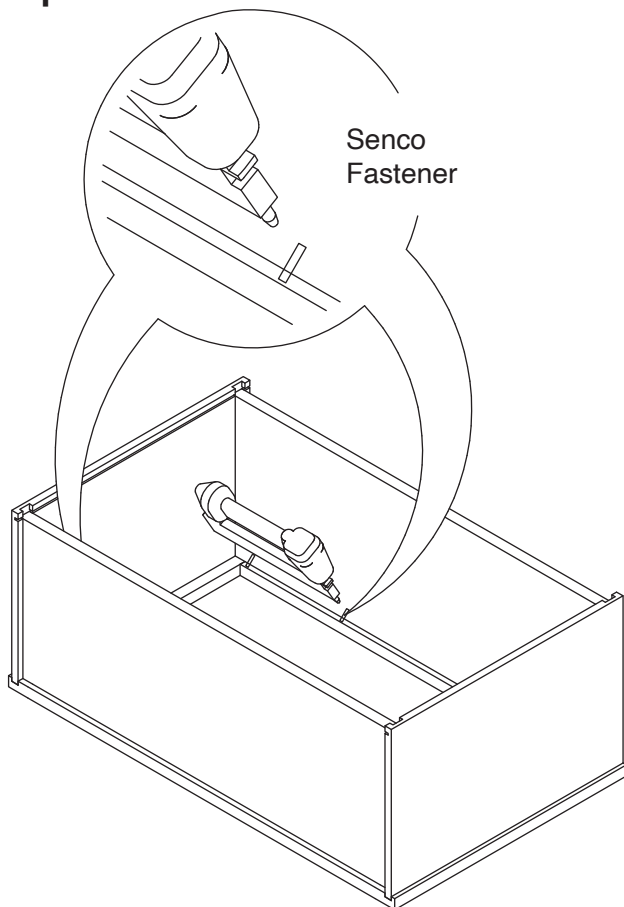

### Step 8:

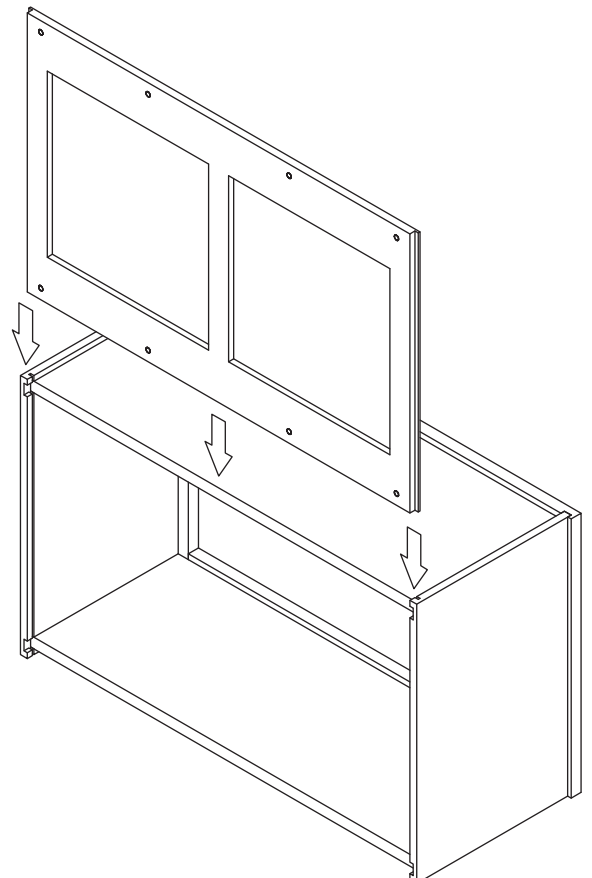

### Step 9:

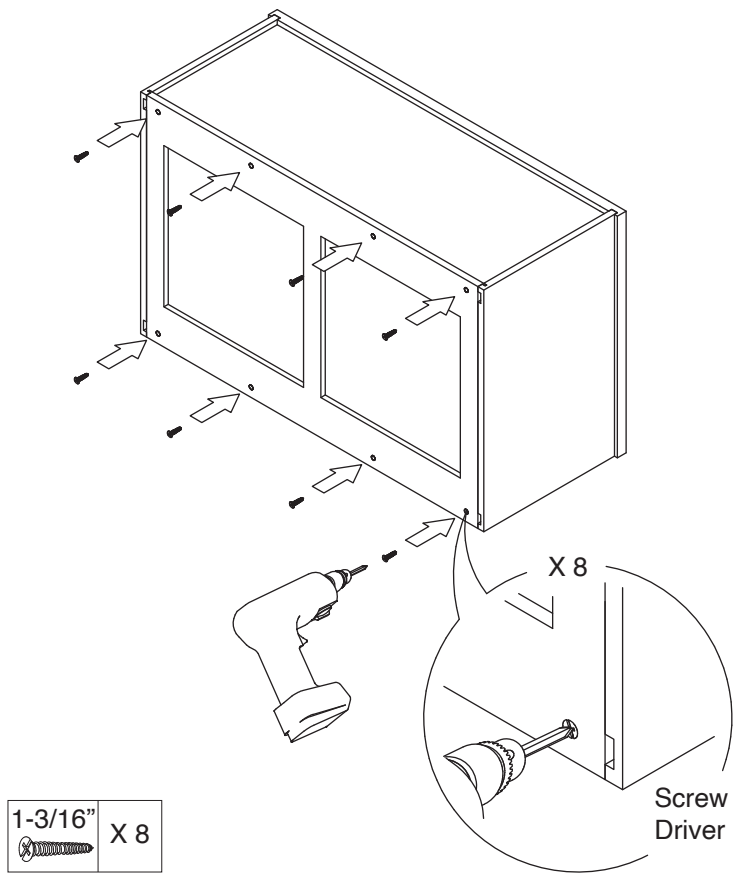

### Step 10:

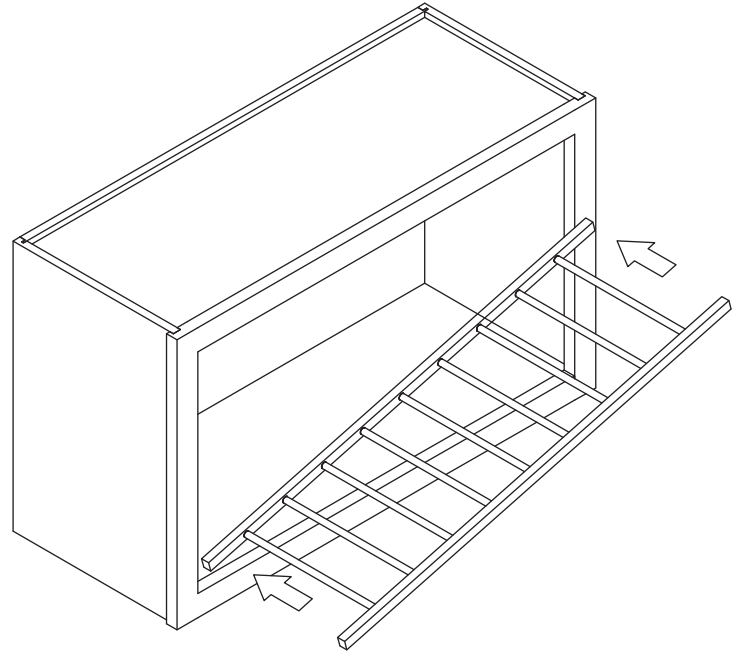

### Step 11:

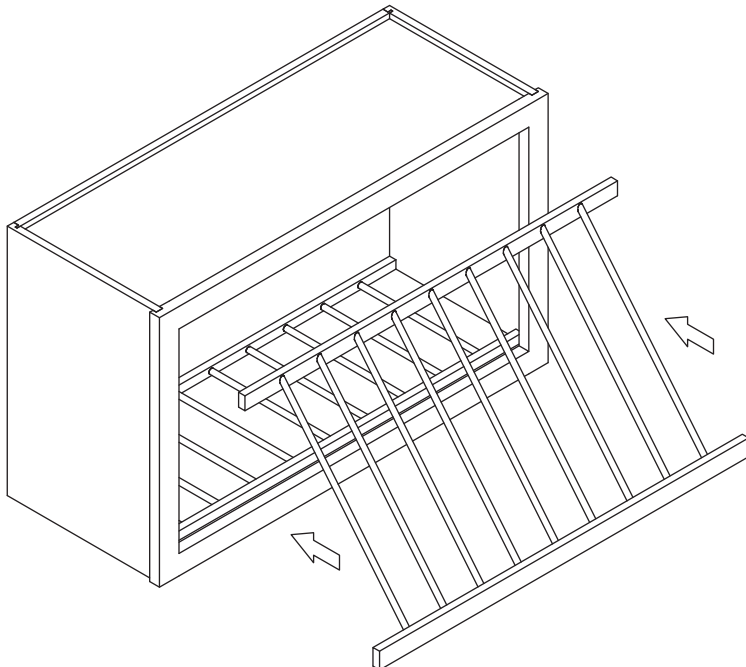

### Step 12:

