

Assembly Instruction

2020 Edition

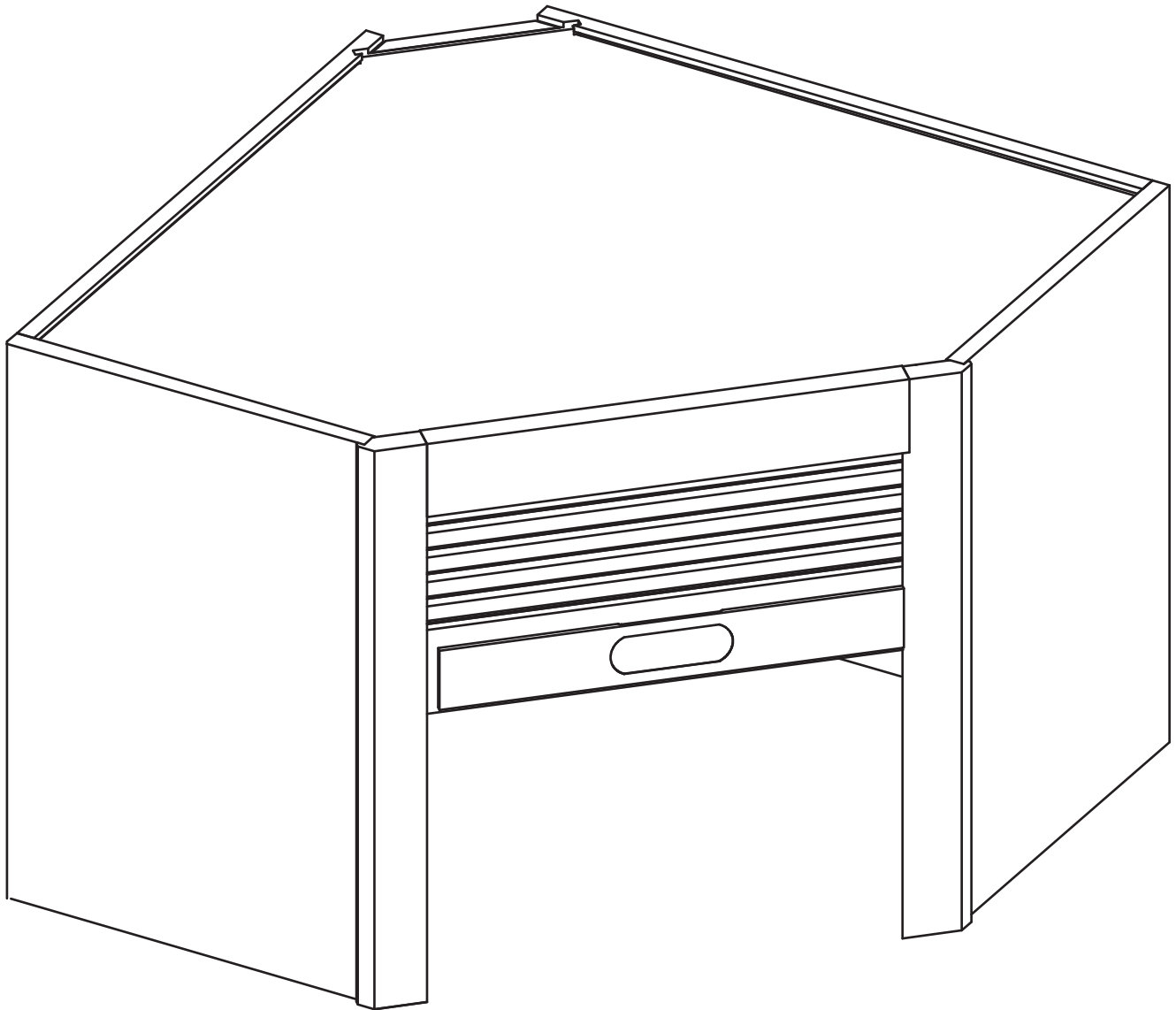

Appliance Garage

Item Code:

AG2418, AG2718

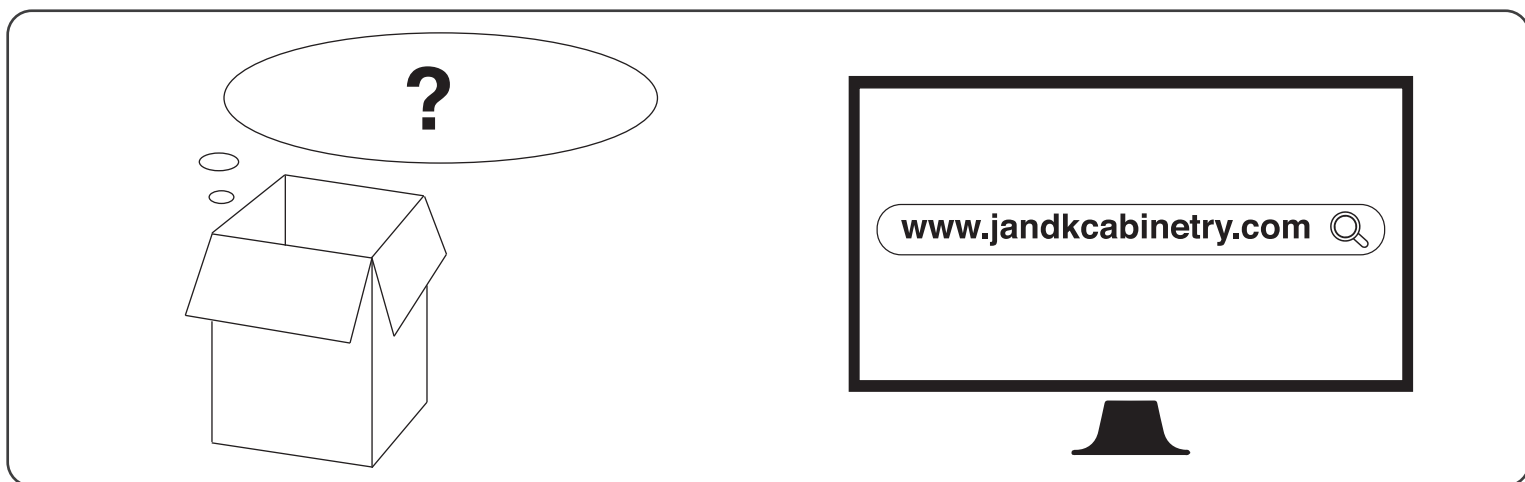
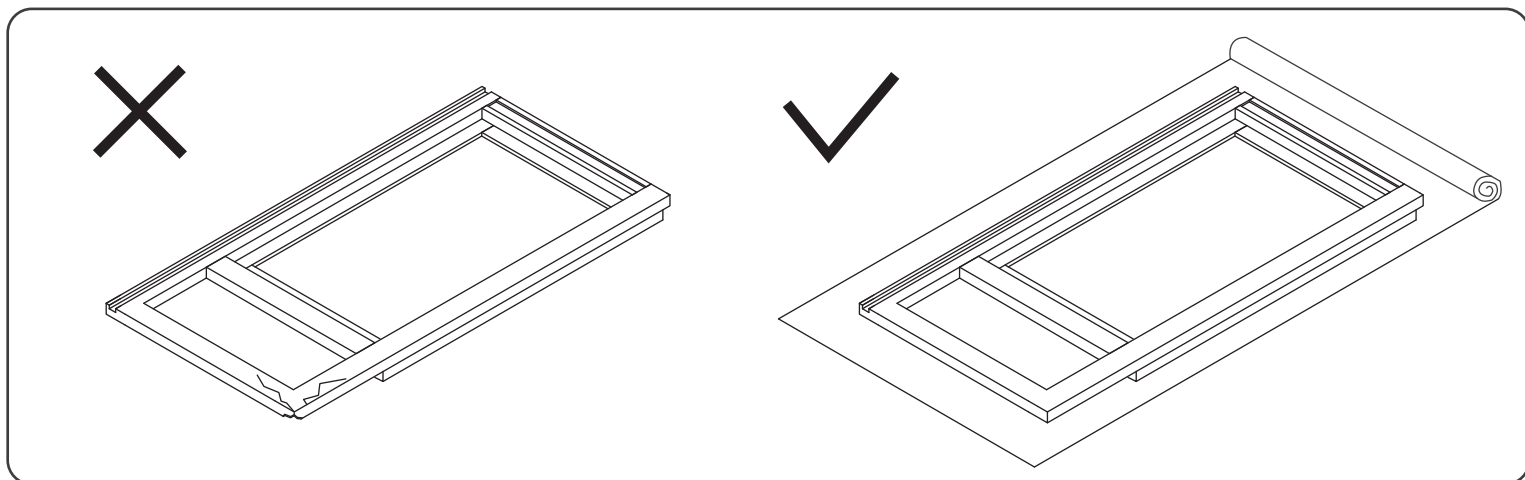

WARNING:

1. Please be careful when opening the box with boxcutter and/or blade.
2. J&K Cabinetry is not responsible for any injuries and/or damages incurred during cabinet assembly.





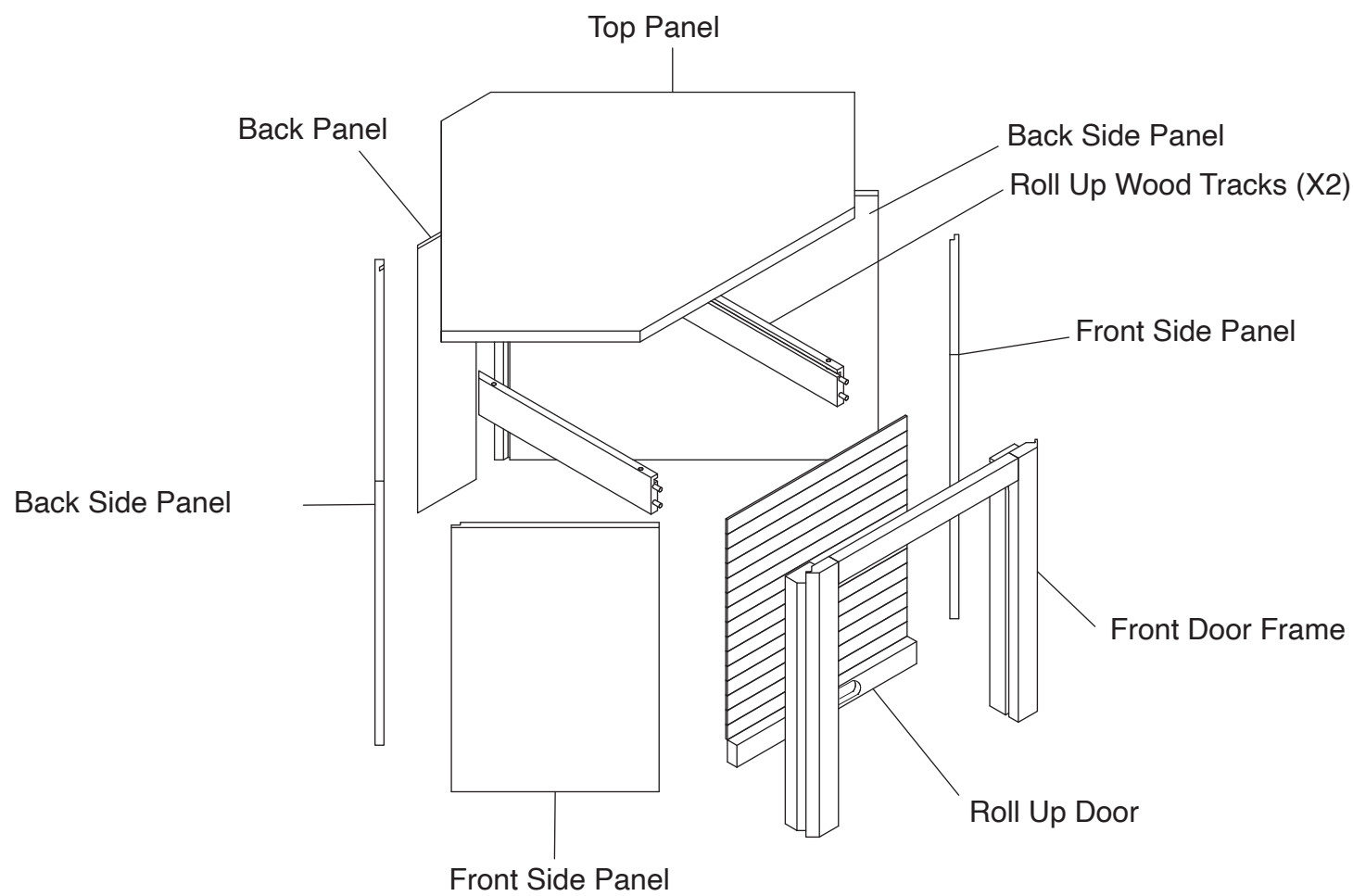

SERVICE:

During the installation process, if you encounter any problems, please go to our official website: www.jandkcabinetry.com, check the full version assembly instruction or watch the assembly video online.

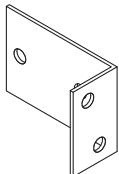
Included Items:



			
90° Brackets X 4	Screws X 16	Screws X 4	Screws X 4

Recommended Tools:

Safety Tools:



Step 1:

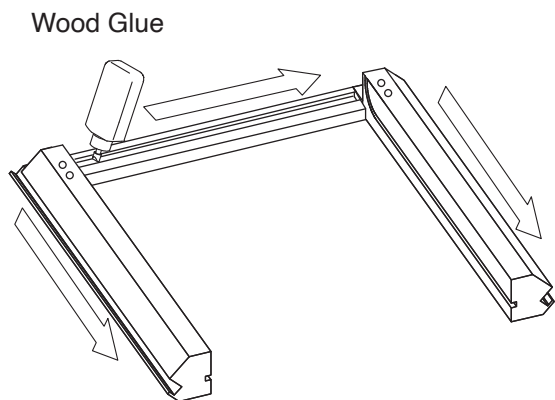

Step 2:

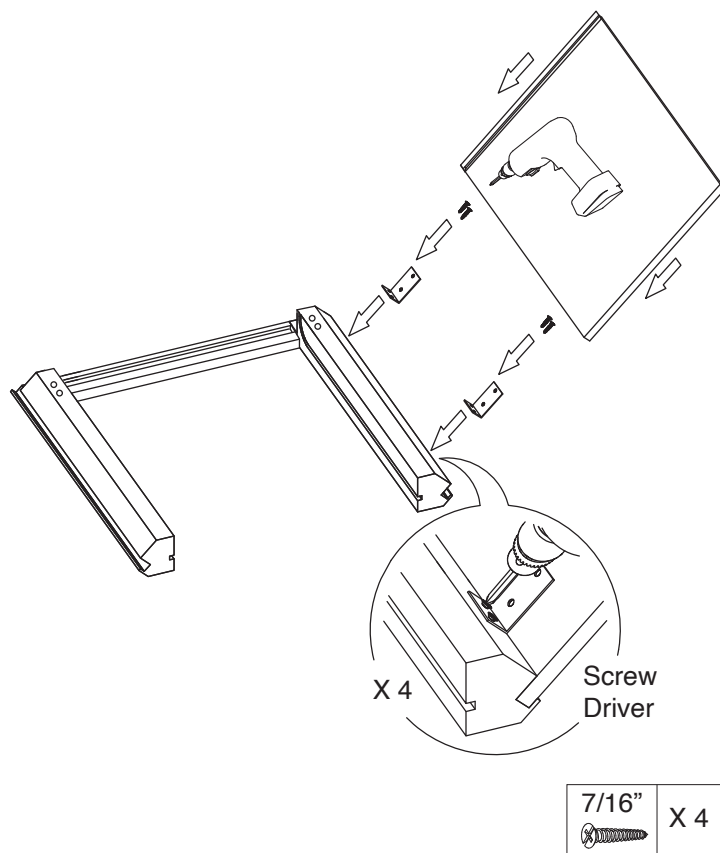

Step 3:

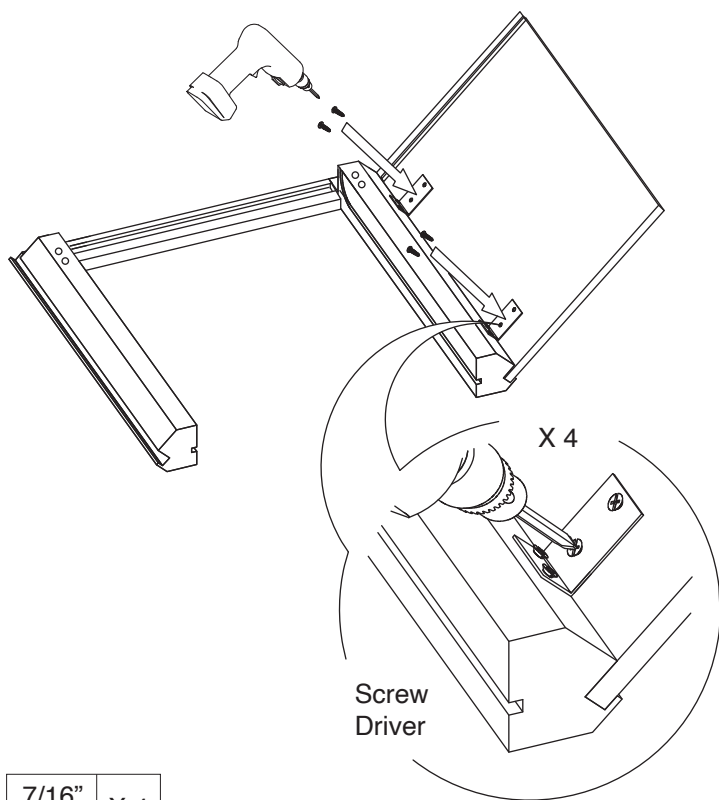

Step 4:

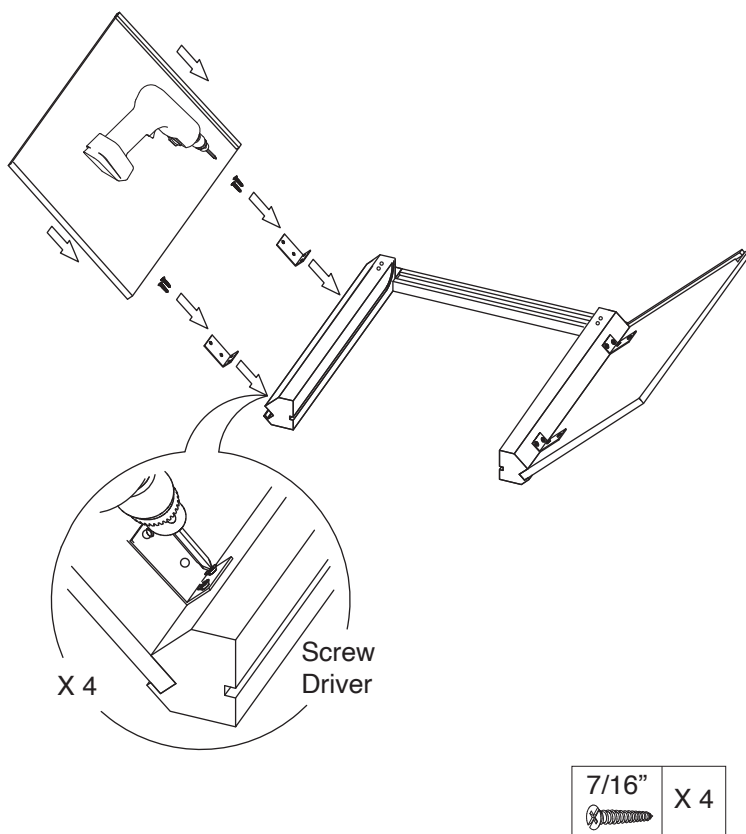

Step 5:

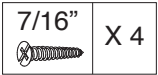
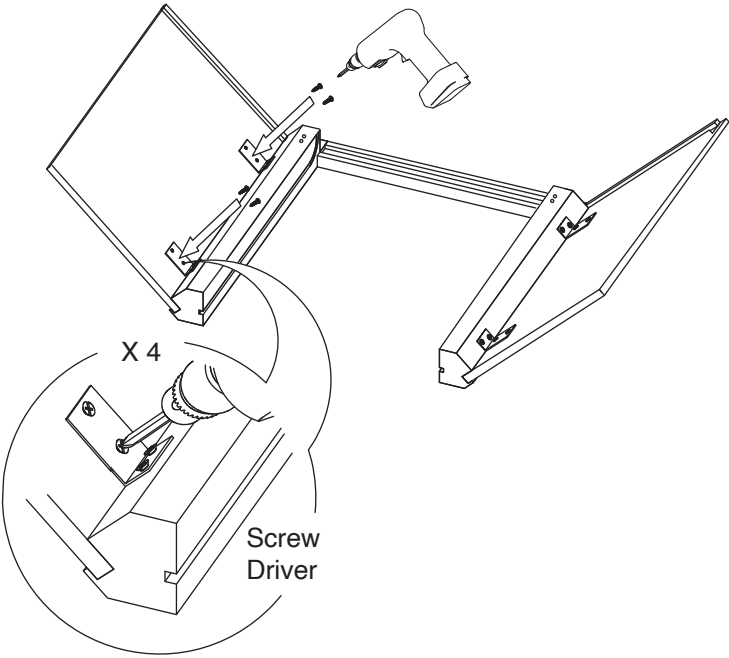

Step 6:

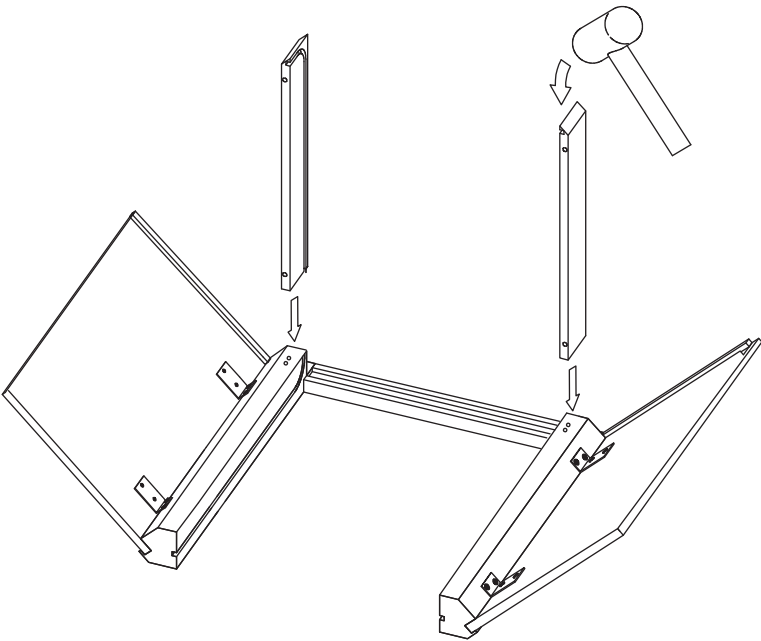

Step 7:

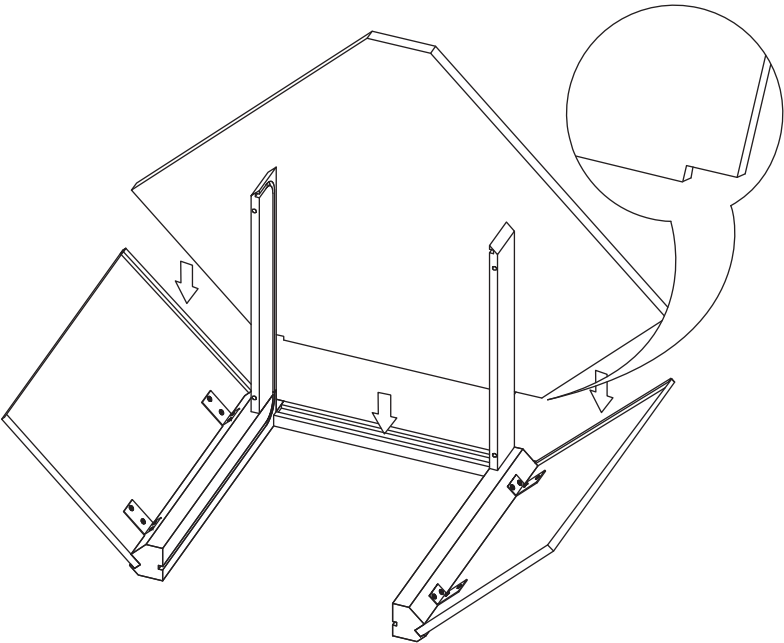

Step 8:

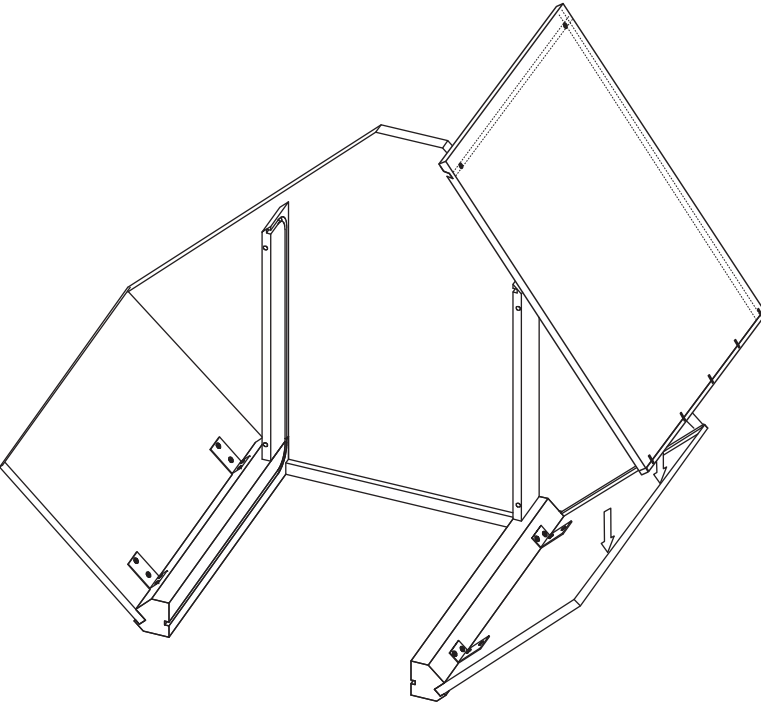

Step 9:

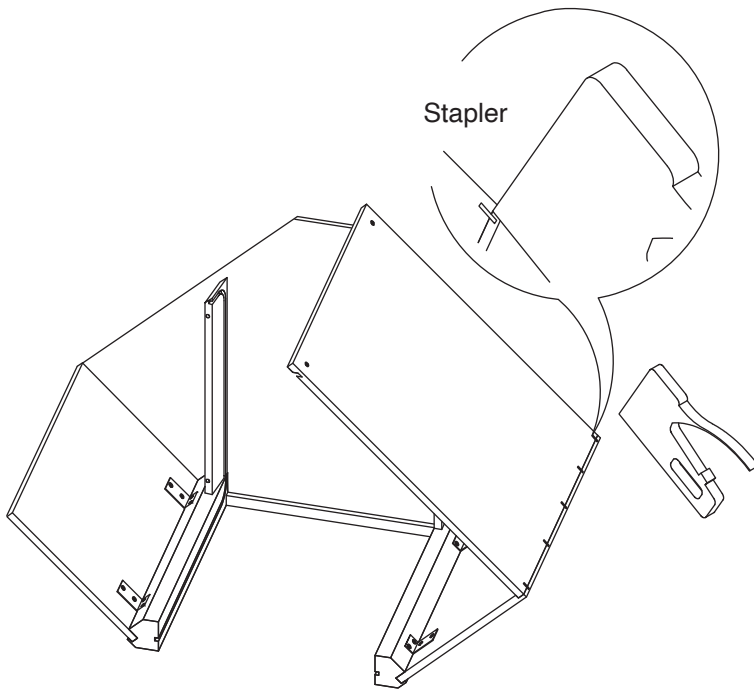

Step 10:

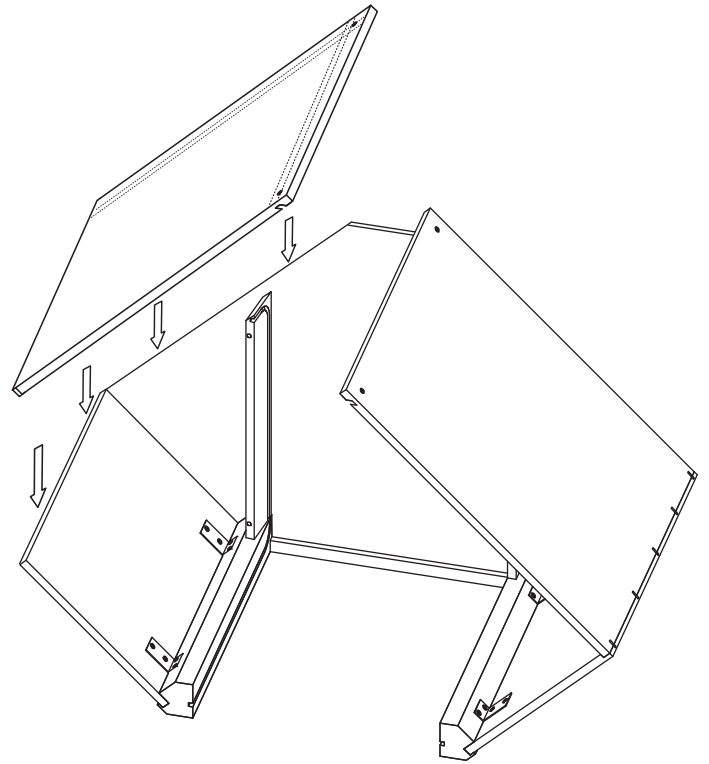

Step 11:

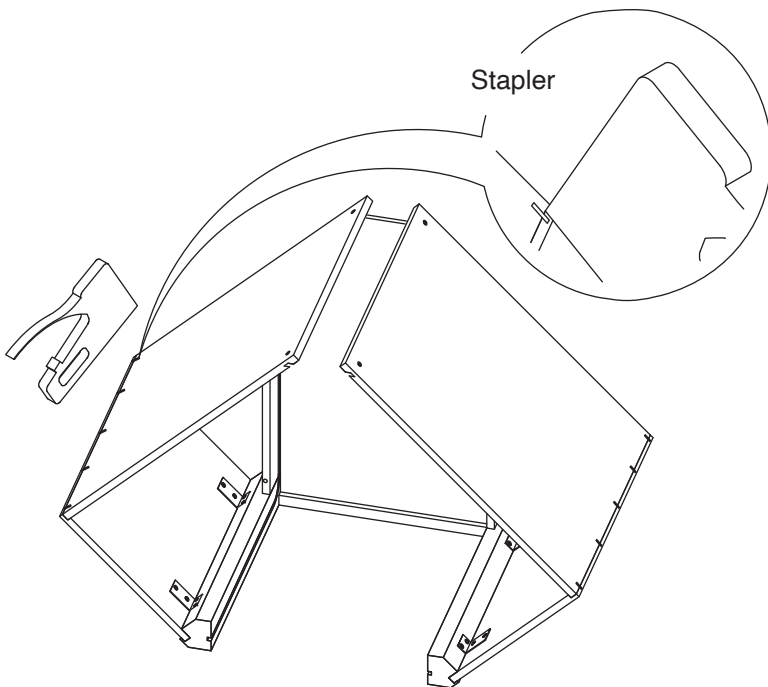

Step 12:

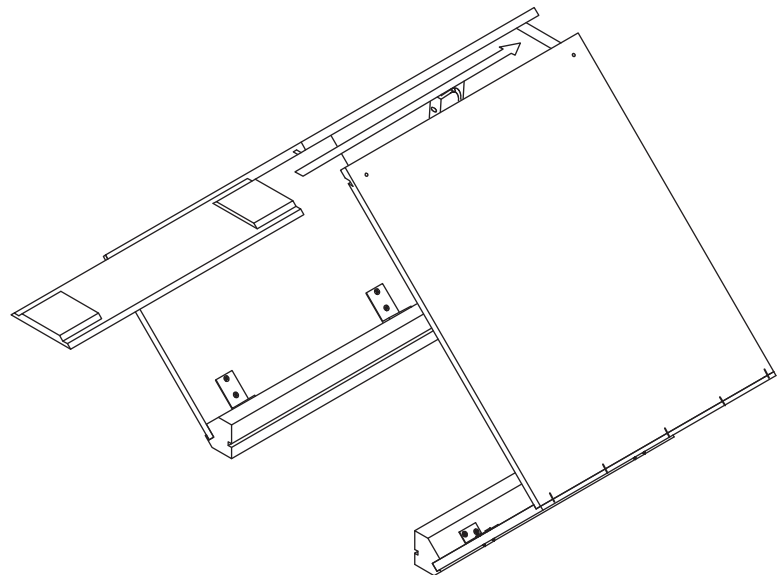

Step 13:

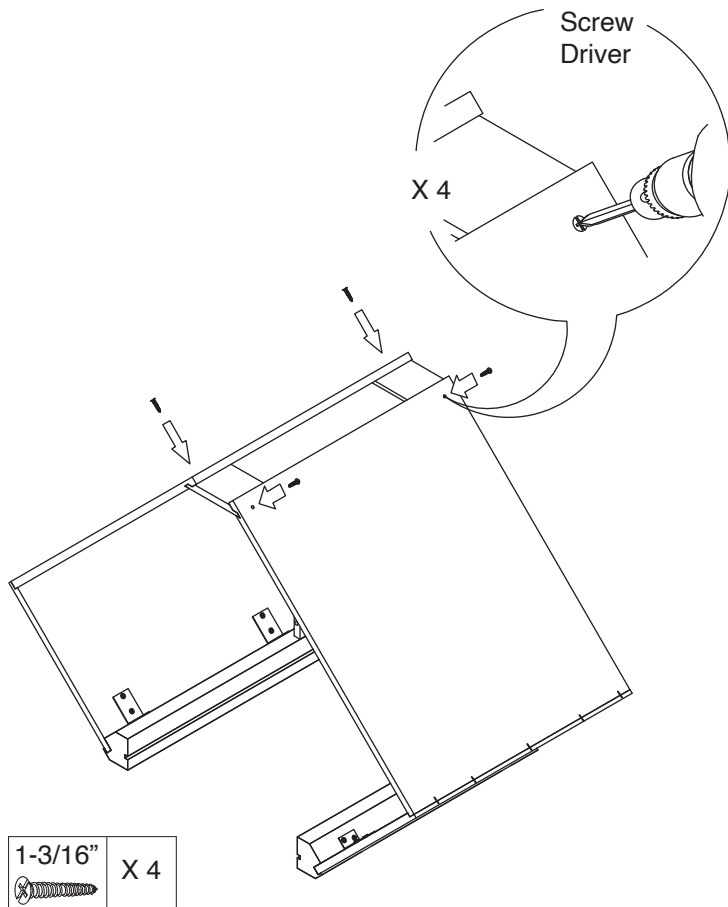

Step 14:

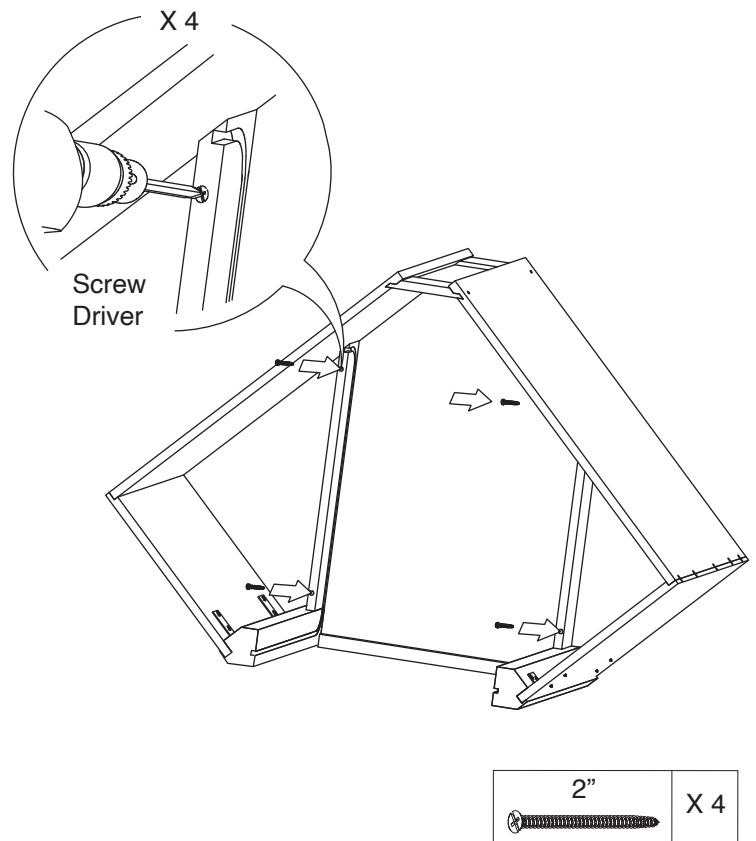

Step 15:

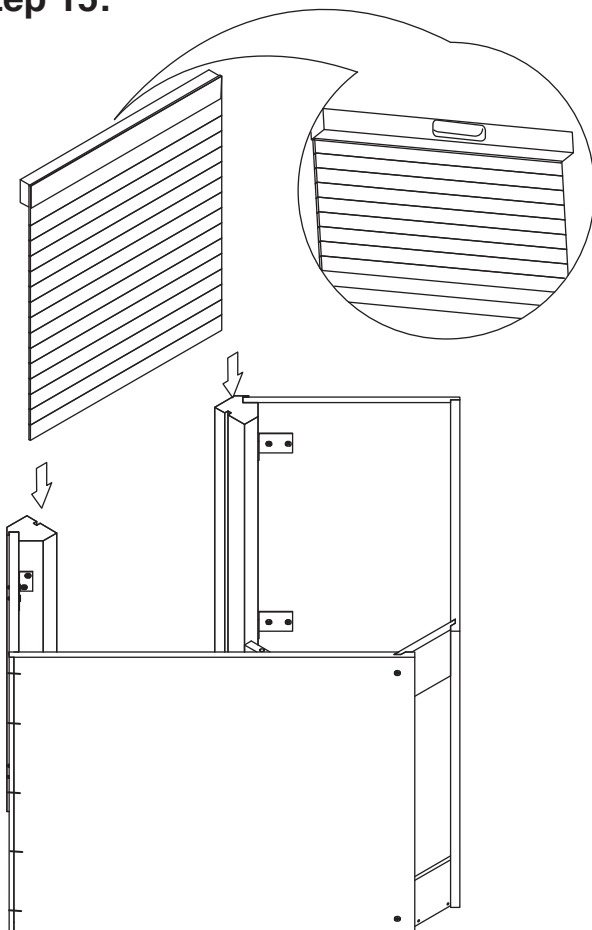

Step 16:

